



The Preston I
Craftsman Edition
Front Elevation
1,896 SF
2,020 SF (with Optional Sunroom)

Drawings are Artist's renderings shown with approximate dimensions and may change without notice.
Some homes will be built as a mirror image depending on unit location and specific site conditions. See Sales Agent for details.



The Preston I

Cotswold Edition

Front Elevation

1,896 SF

2,020 SF (with Optional Sunroom)

Drawings are Artist's renderings shown with approximate dimensions and may change without notice.
Some homes will be built as a mirror image depending on unit location and specific site conditions. See Sales Agent for details.



The Preston I
Federal Edition
Front Elevation
1,896 SF
2,020 SF (with Optional Sunroom)

Drawings are Artist's renderings shown with approximate dimensions and may change without notice.
Some homes will be built as a mirror image depending on unit location and specific site conditions. See Sales Agent for details.



(Optional Master Bath)

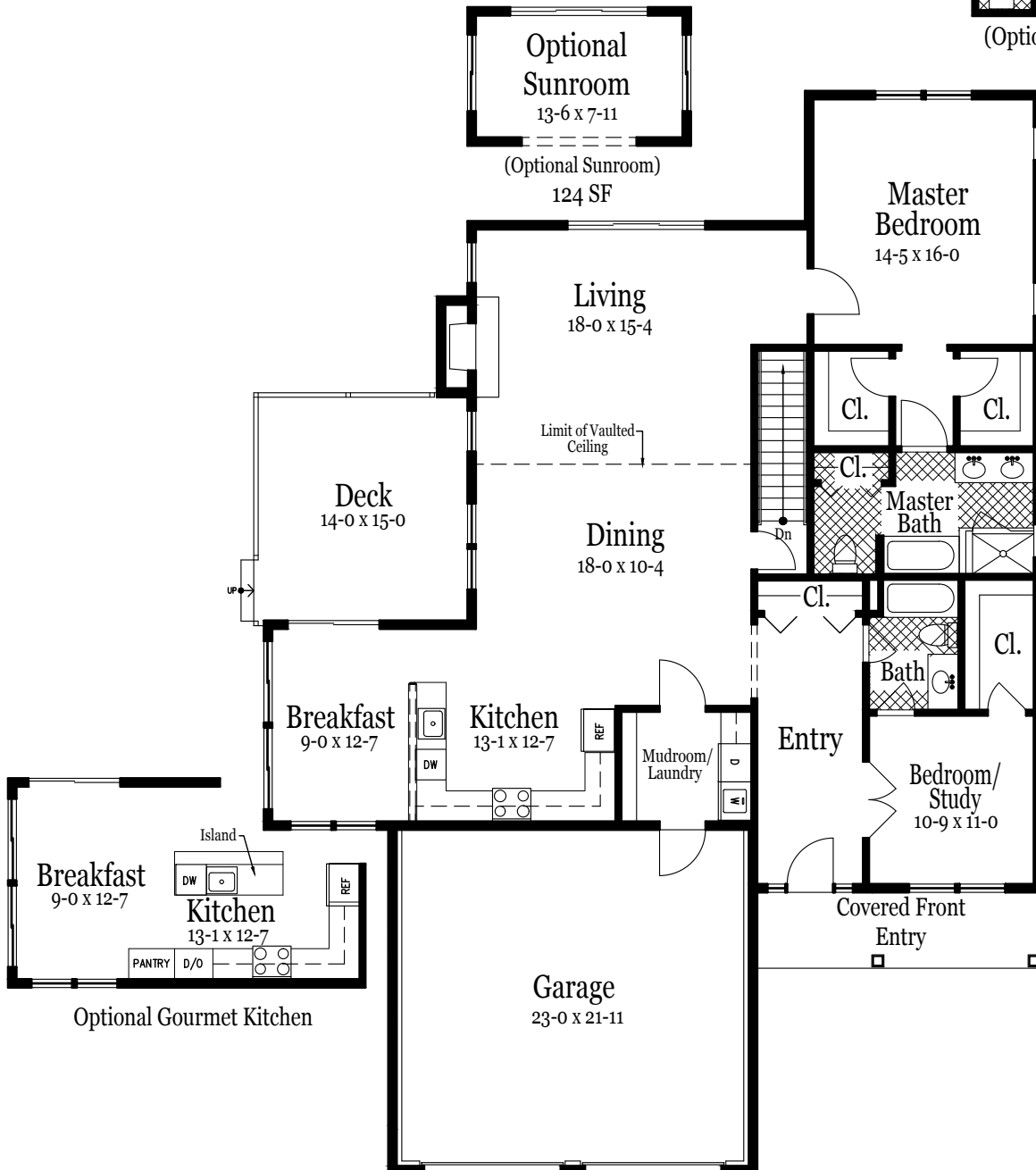

The Preston I

First Level Plan
 1,896 SF
 2,020 SF (with Optional Sunroom)

Drawings are Artist's renderings shown with approximate dimensions and may change without notice.
 Some homes will be built as a mirror image depending on unit location and specific site conditions. See Sales Agent for details.

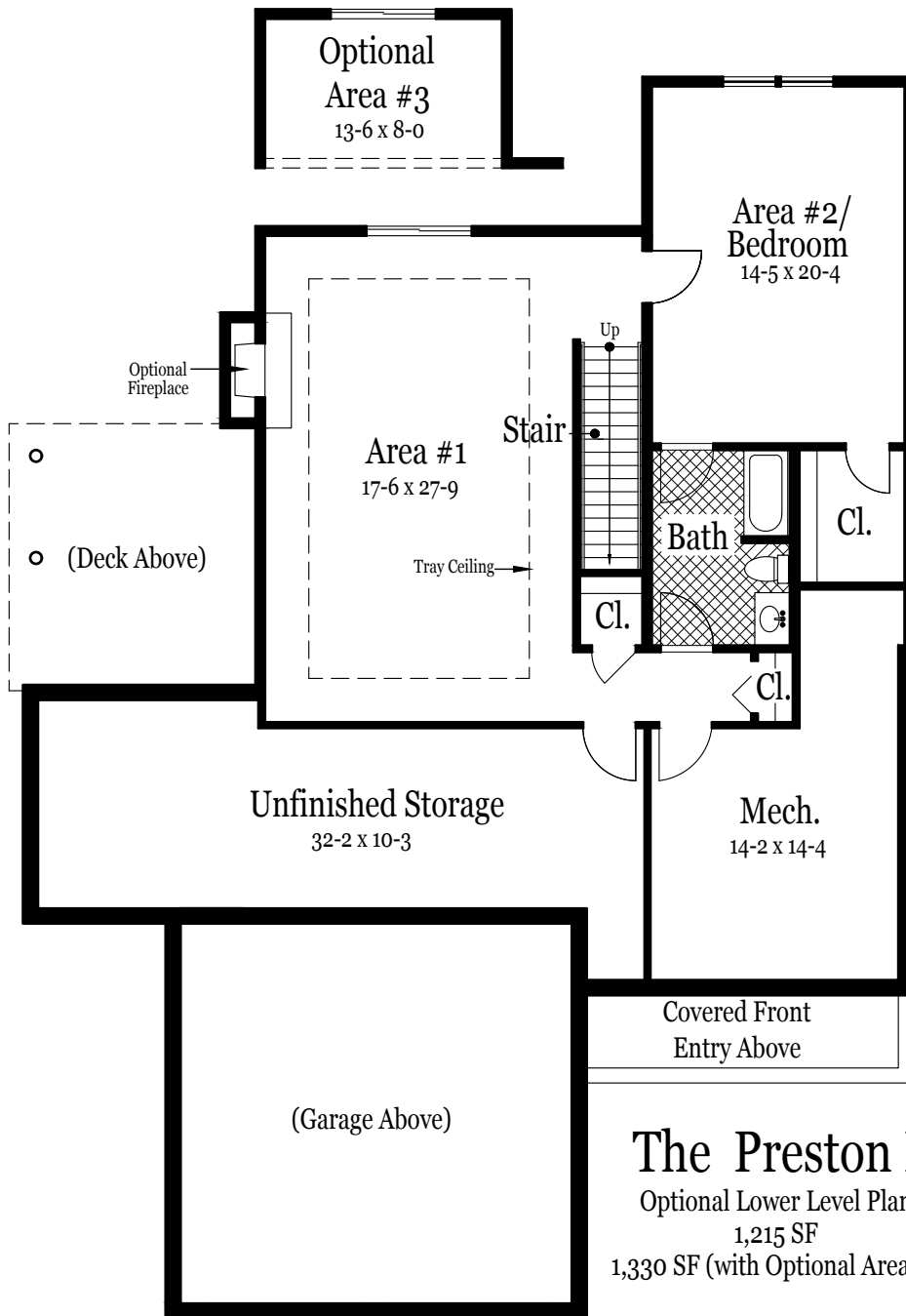

The Preston I
 Optional Lower Level Plan
 1,215 SF
 1,330 SF (with Optional Area #3)

Drawings are Artist's renderings shown with approximate dimensions and may change without notice.
 Some homes will be built as a mirror image depending on unit location and specific site conditions. See Sales Agent for details.