



The Preston II
Craftsman Edition
Front Elevation
2,611 SF

Drawings are Artist's renderings shown with approximate dimensions and may change without notice.
Some homes will be built as a mirror image depending on unit location and specific site conditions. See Sales Agent for details.



The Preston II

Cotswold Edition

Front Elevation
2,611 SF

Drawings are Artist's renderings shown with approximate dimensions and may change without notice.
Some homes will be built as a mirror image depending on unit location and specific site conditions. See Sales Agent for details.



The Preston II
Federal Edition
Front Elevation
2,611 SF

Drawings are Artist's renderings shown with approximate dimensions and may change without notice.
Some homes will be built as a mirror image depending on unit location and specific site conditions. See Sales Agent for details.



(Optional Master Bath)



Optional Sunroom
13-6 x 7-11
(Optional Sunroom)
124 SF

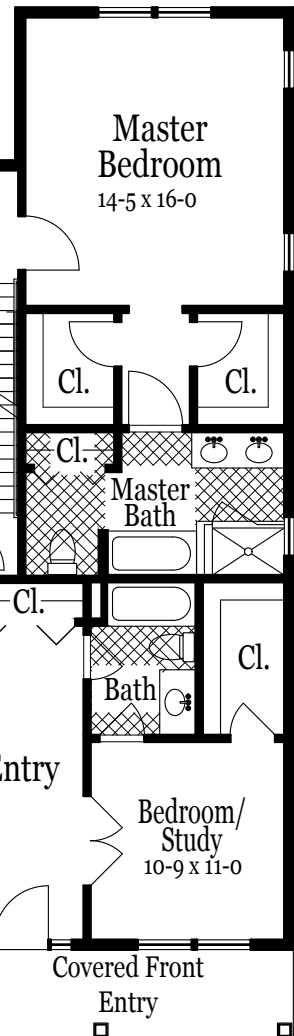

Master Bedroom
14-5 x 16-0

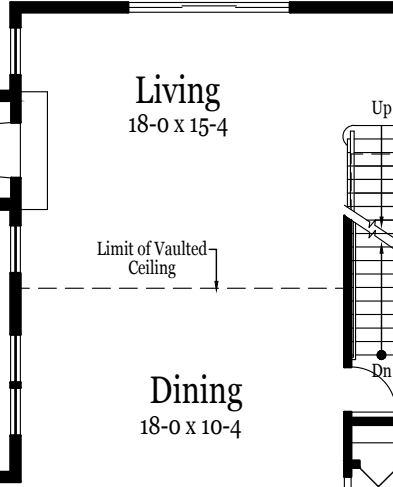

Living
18-0 x 15-4

Dining
18-0 x 10-4

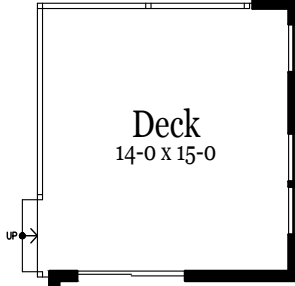

Deck
14-0 x 15-0

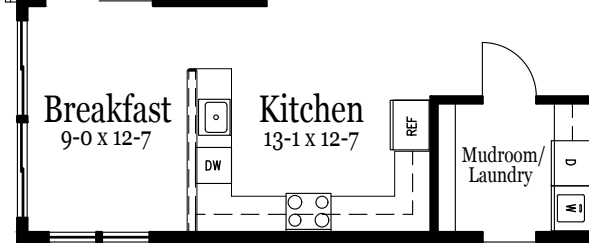

Breakfast
9-0 x 12-7

Kitchen
13-1 x 12-7

Mudroom/
Laundry

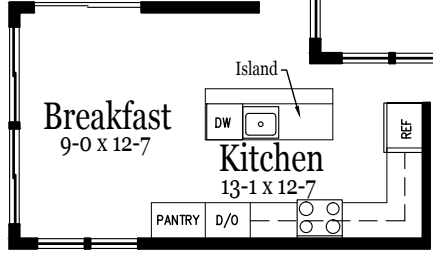

Breakfast
9-0 x 12-7

Kitchen
13-1 x 12-7

Optional Gourmet Kitchen

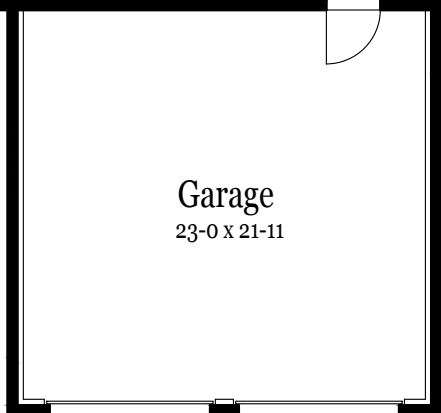

Garage
23-0 x 21-11



Entry

Bedroom/
Study
10-9 x 11-0

Covered Front
Entry

The Preston II

First Level Plan
1,896 SF
2,020 SF (with Optional Sunroom)

Drawings are Artist's renderings shown with approximate dimensions and may change without notice.
Some homes will be built as a mirror image depending on unit location and specific site conditions. See Sales Agent for details.

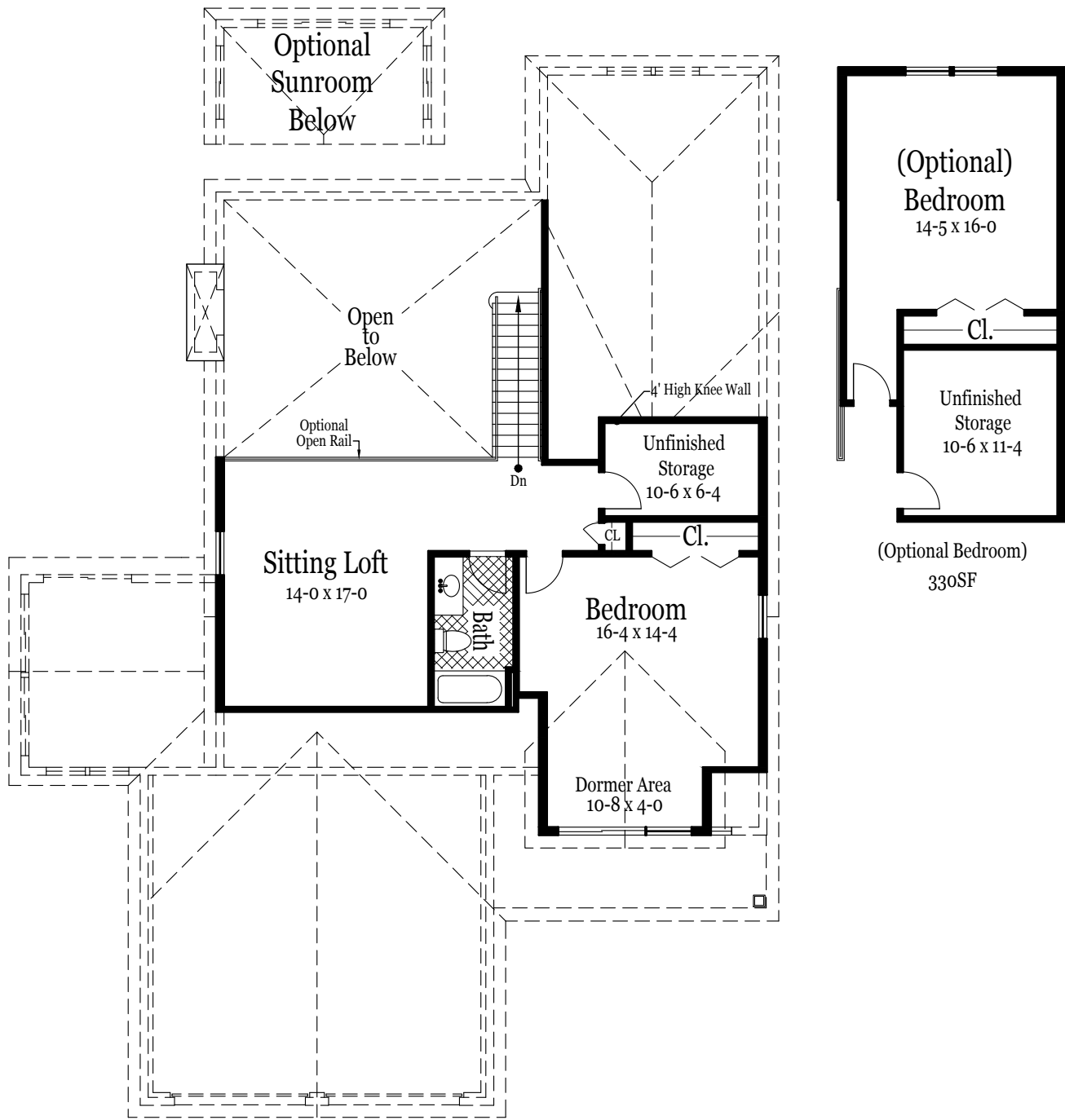

The Preston II
 Second Level Plan
 715 SF
 1,075 SF (with Optional Bedroom)

Drawings are Artist's renderings shown with approximate dimensions and may change without notice.
 Some homes will be built as a mirror image depending on unit location and specific site conditions. See Sales Agent for details.

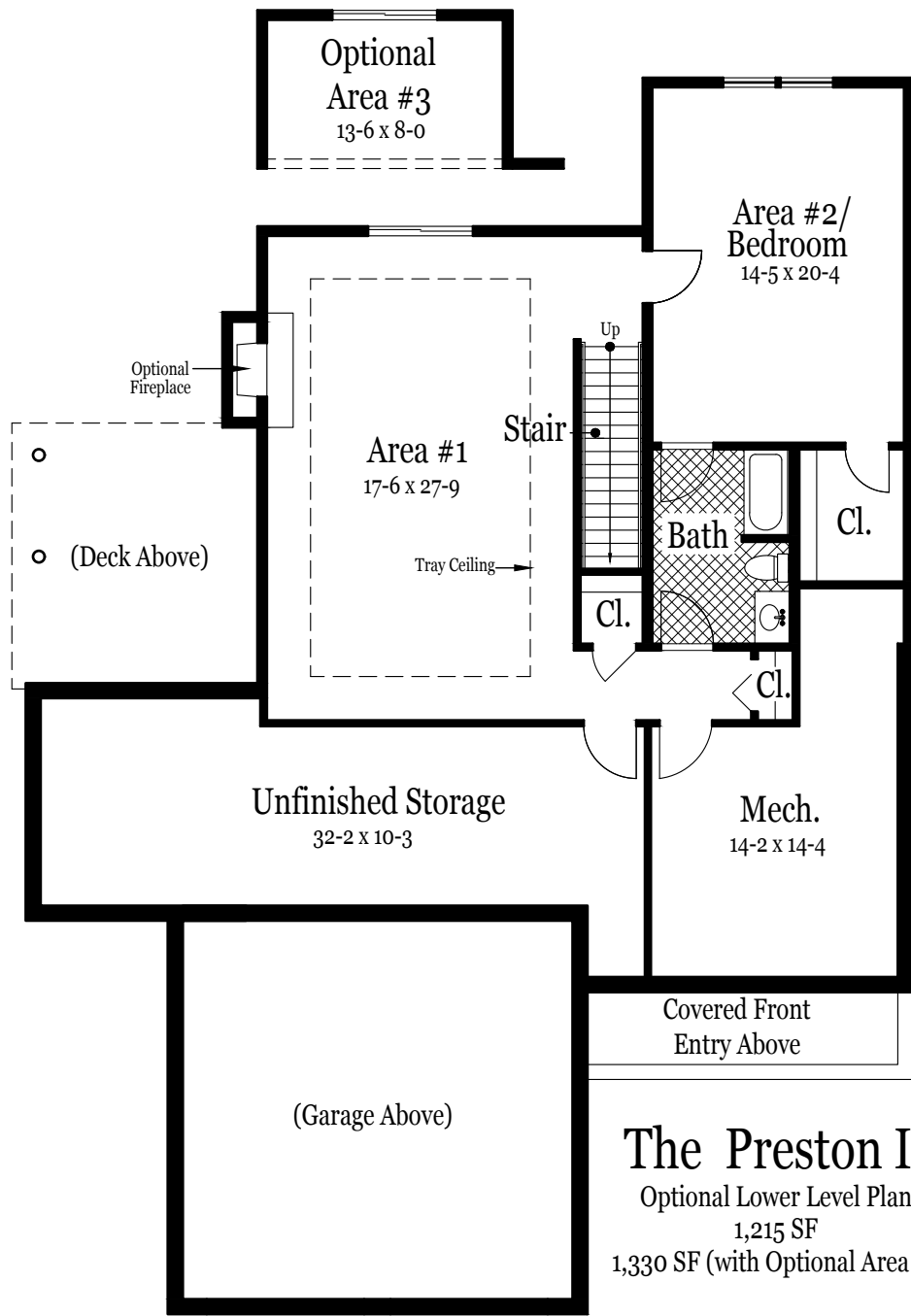

Drawings are Artist's renderings shown with approximate dimensions and may change without notice.
 Some homes will be built as a mirror image depending on unit location and specific site conditions. See Sales Agent for details.